

PLAN VIEW

N. T. S.

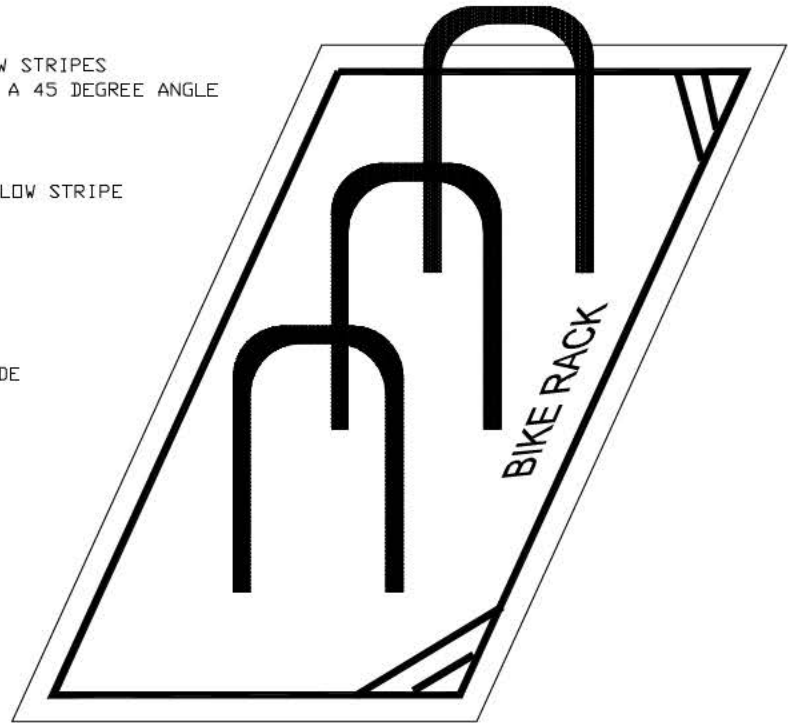

PERSPECTIVE VIEW

N. T. S.

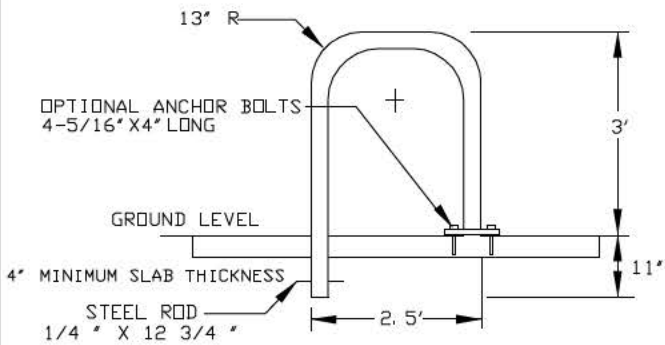

SECTION VIEW

N. T. S.

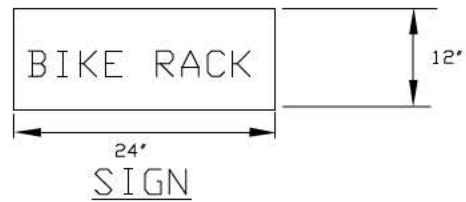

1. THE BICYCLE RACK SHALL BE AN INVERTED "U", "A", "POST - AND- LOOP" OR OTHER TYPE THAT MEETS REQUIREMENTS CONTAINED IN SECTION 4. 11. 6. 3 OF THE CITY OF LAKELAND LAND DEVELOPMENT CODE.
2. THE BICYCLE RACK SHALL BE P. V. C. COATED, METAL PIPE RACK.
3. THE BICYCLE RACK SHALL BE IDENTIFIED WITH PAVEMENT MARKINGS OR SIGNAGE.
3. THE RACK MAY BE ATTACHED ACCORDING TO EITHER OF THE METHODS SHOWN. USING THE FLANGE WITH ANCHOR BOLTS MAY REQUIRE ADDITIONAL CONCRETE SLAB THICKNESS. OTHER ANCHORING SYSTEMS MAY BE CONSIDERED UPON APPROVAL IN ADVANCE WITH THE CITY INSPECTOR IF REQUIRED BY THE MANUFACTURER.
4. THE STRIPING AND LETTERING SHOWN SHALL BE HIGH VISIBILITY REFLECTIVE YELLOW PAINT OR THERMOPLASTIC MEETING FDOT SPECIFICATIONS.
5. THE SIGN SHALL BE PLACED 5 FEET FROM GROUND AND EITHER PLACED ON A POST OR WALL IF AVAILABLE.

CITY OF LAKELAND, FLORIDA STANDARD DETAILS				
BIKE RACK				
REVISED	3/21/14	SCALE	SHEET NO.	INDEX NO.
REVISED	1/9/12	N.T.S.	5 of 5	900
REVISED	6/25/10			
DATE	5/19/09			